



F.P.Z. Inc
 2091 N. Port Washington Rd
 Grafton, WI, 53024 - U.S.A.
 Tel. (262) 375-7360
 Fax (262) 375-7361
 E-mail usa@fpz.com

REGENERATIVE BLOWERS - VACUUM
SCL K07 / K08 / K09 / K10 / K11

MS SERIE - MOR RANGE

SN 1810-2 1/2

effepizeta

TECHNICAL CHARACTERISTICS

- Aluminium alloy construction
- Smooth operation
- High efficiency impeller
- Maintenance free
- Mountable in any position

OPTIONS

- Special voltages (IEC 38)
- Surface treatments

ACCESSORIES

- Inlet and/or inline filters
- Additional inlet/outlet silencers
- Safety valves
- Flow converting device
- Optional connectors

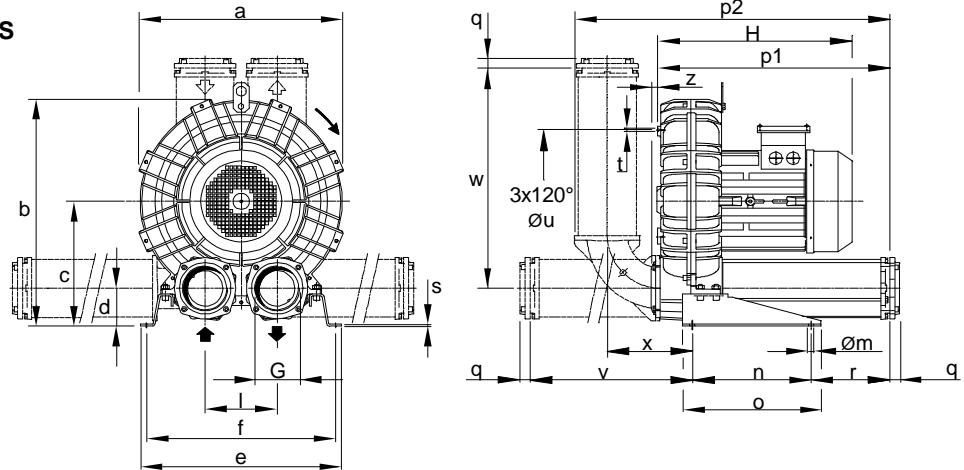

Model	a	b	c	d	e	f	G	l	m	n	o	p1	p2	q	r	s	t	u	v	w	x	z
K07-MS	16.69	18.94	10.59	3.23	18.43	17.24	3" NPT	6.10	0.51	11.81	13.78	20.16	27.24	0.98	5.39	0.20	M8	11.61	17.44	18.94	7.20	0.63
K08-MS	17.99	19.61	10.59	3.23	18.82	17.64	3" NPT	6.10	0.51	11.81	13.78	20.16	27.24	0.98	5.39	0.20	M8	12.20	17.44	18.94	7.20	0.63
K09-MS																						
K10-MS	20.31	22.56	12.40	3.78	20.00	18.82	4" NPT	7.17	0.51	11.81	13.78	23.07	31.38	0.98	7.83	0.20	M8	14.17	19.88	21.89	8.46	0.63
K11-MS																						

Model	Maximum flow cfm		Installed power Hp		Maximum differential pressure Δp (In Hg)		Noise level Lp dB (A) (1)		Overall dimensions H Inches	Weight Lbs
	60 Hz 3500 rpm	50 Hz 2900 rpm	60 Hz 3500 rpm	50 Hz 2900 rpm	60 Hz 3500 rpm	50 Hz 2900 rpm	60 Hz 3500 rpm	50 Hz 2900 rpm		
K07-MS	294	243	4	3 1/3	3.7	4.6	81.6	79.6	16.1	104.50
	294	243	5	4 1/6	5.6	6.3	81.9	79.9	16.1	112.20
	294	243	7 1/2	6 1/4	9.6	8.9	82.2	80.2	17.5	135.20
	294	-	10	-	11.1	-	82.5	-	17.5	146.30
K08-MS	381	316	5	4 1/6	2.9	3.8	85.3	83.3	16.1	115.70
	381	316	7 1/2	6 1/4	5.9	6.6	85.6	83.6	17.5	138.90
	381	316	10	8 1/3	8.5	9.2	85.9	83.9	17.5	150.00
	381	-	15	-	11.1	-	86.2	-	17.5	170.80
K09-MS										
K10-MS	556	460	7 1/2	6 1/4	2.7	3.8	86.1	84.1	17.95	165.30
	556	460	10	8 1/3	4.7	5.9	86.4	84.4	17.95	176.40
	556	460	15	12 1/2	8.8	9.9	86.7	84.7	19.37	198.40
	556	-	20	-	11.1	-	87.0	-	23.05	253.00
K11-MS										

(1) Noise measured at 1 m distance with inlet and outlet ports piped, in accordance to ISO 3744.

- For proper use, the blower should be equipped with inlet filter and safety valve; other accessories available on request.
- Ambient temperature from +5° to +104°F.
- Specifications subject to change without notice.

F.P.Z. GmbH
 Kilianstraße 142
 90425 Nürnberg - DEUTSCHLAND
 Tel. +49 (0)911 36 78 68-00
 Fax +49 (0)911 36 78 68-01
 E-mail deutschland@fpz.com

F.P.Z. France S.a.r.l.
 6, Avenue du 24 Août 1944
 69960 Corbas - FRANCE
 Tel. +33 (0)472 50 13 13
 Fax +33 (0)472 50 03 40
 E-mail france@fpz.com

FPZ. effepizeta srl
 Via F.lli Cervi 16/18
 20049 Concorezzo - (MI) - ITALY
 Tel. (039) 604 1820 r.a.
 Fax (039) 604 1296
 E-mail italia@fpz.com

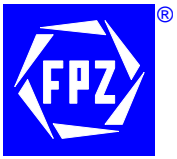

REGENERATIVE BLOWERS - VACUUM SCL K07 / K08 / K09 / K10 / K11

MS SERIE - MOR RANGE

SN 1810-2 2/2

effepizeta

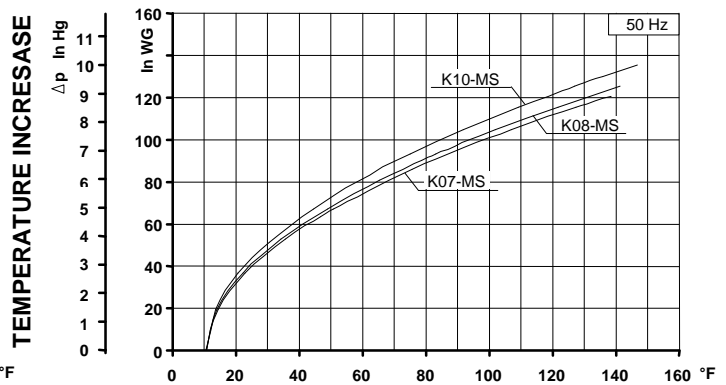
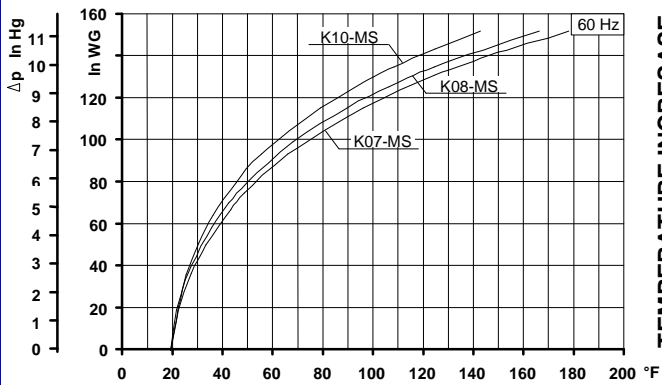
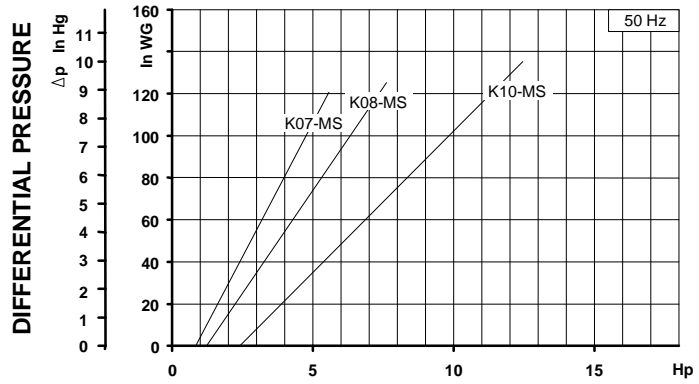
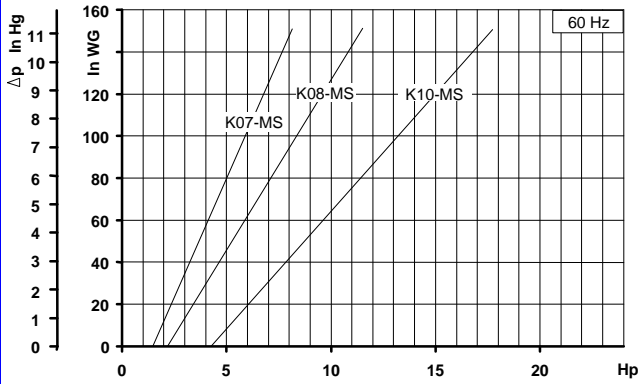
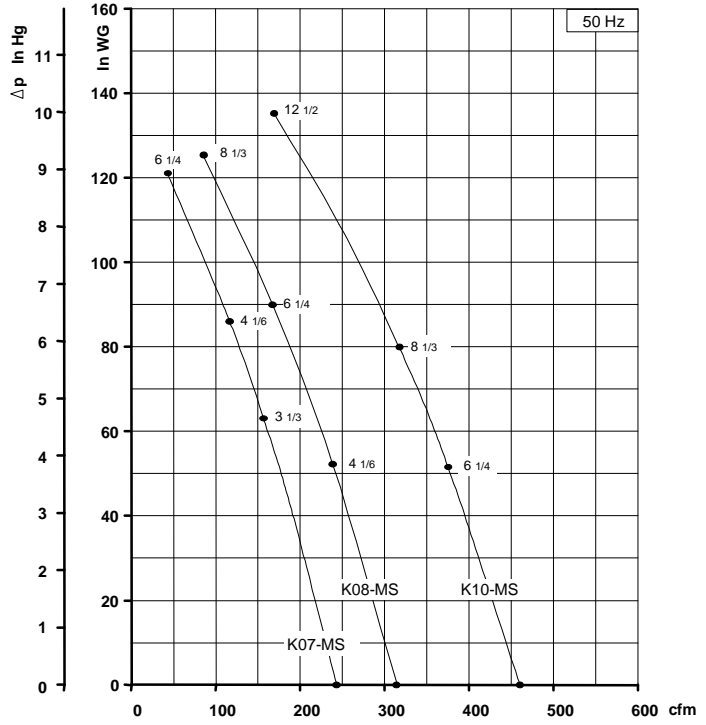
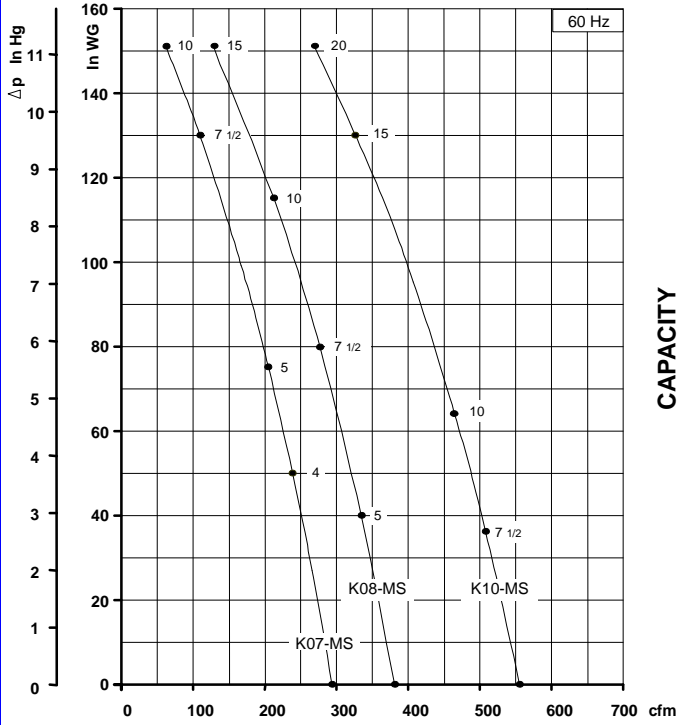

Curves refer to air at 68° F temperature, measured at inlet port and 29.92 In Hg atmospheric backpressure (abs).
Tolerance on given values ±10% - data can change without prior notice.